



**WACKER
NEUSON**

Operation and Safety Guide

Wacker Neuson Dewatering Pump

PG 1

Vendor Website: www.wackerneuson.com

Support Phone No. 1-800-770-0957



WARNING



SAFETY TOPICS:

Familiarity and proper training are required for the safe operation of the machine. Machines operated improperly or by untrained personnel can be hazardous. Read the operating instructions contained in this manual and the engine manual, and familiarize yourself with the location and proper use of all controls. Inexperienced operators should receive instruction from someone familiar with the machine before being allowed to operate it.

Please visit www.wackerneuson.com



SAFETY CHECKLIST:

1. Do not pump volatile, flammable, or low flash point fluids. These fluids could ignite or explode. Do not pump corrosive chemicals or water containing toxic substances. These fluids could create serious health and environmental hazards.
2. Do not open the priming plug when the pump is hot. Do not loosen or remove inlet or discharge hose fittings when the pump is hot.
3. Do not open pump housing cover while pump is operating, or start pump with the cover off. The rotating impeller inside the pump can cut or sever objects caught in it.
4. Do not block or restrict flow from inlet line or discharge line.



WARNING: The instructions on this sheet are abbreviated instructions only and are provided solely as a customer service. They are not meant to replace the machine's operation manual. If you are unsure of the machine's safe and proper operation, please review the operating and safety information in the operator's manual provided with the machine.

Tool Application: This machine is intended for the pumping of clear water, or water containing solids up to the size stated within the product specifications.

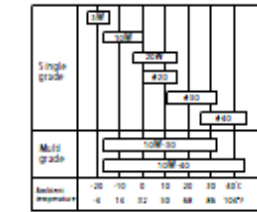
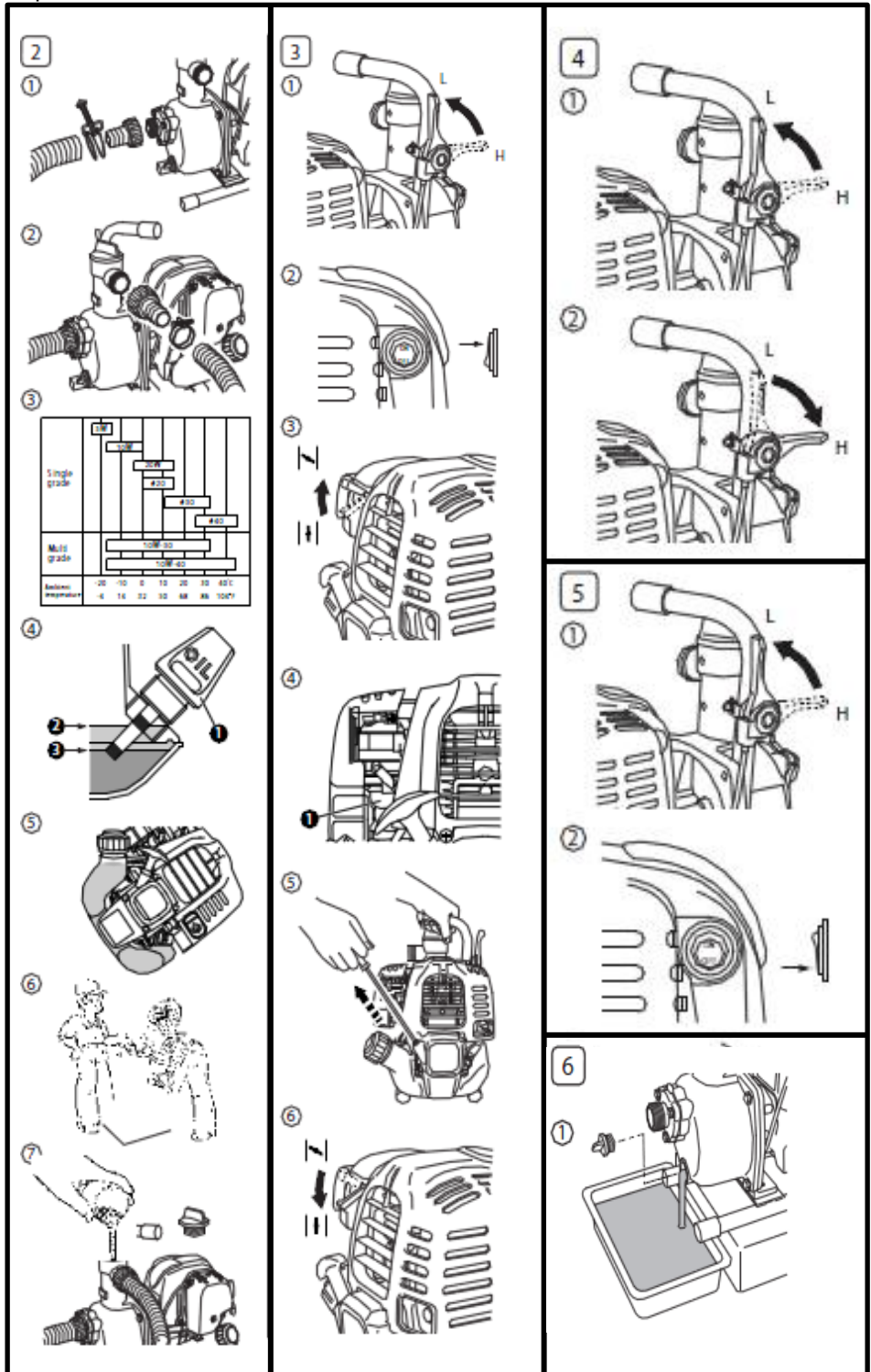



**WACKER
NEUSON**

Operation and Safety Guide

Wacker Neuson Dewatering Pump

PG 1

Vendor Website: www.wackerneuson.com

Support Phone No. 1-800-770-0957



WARNING



SAFETY TOPICS:

Familiarity and proper training are required for the safe operation of the machine. Machines operated improperly or by untrained personnel can be hazardous. Read the operating instructions contained in this manual and the engine manual, and familiarize yourself with the location and proper use of all controls. Inexperienced operators should receive instruction from someone familiar with the machine before being allowed to operate it. Please visit www.wackerneuson.com

SAFETY CHECKLIST:

1. Do not pump volatile, flammable, or low flash point fluids. These fluids could ignite or explode. Do not pump corrosive chemicals or water containing toxic substances. These fluids could create serious health and environmental hazards.
2. Do not open the priming plug when the pump is hot. Do not loosen or remove inlet or discharge hose fittings when the pump is hot.
3. Do not open pump housing cover while pump is operating, or start pump with the cover off. The rotating impeller inside the pump can cut or sever objects caught in it.
4. Do not block or restrict flow from inlet line or discharge line.

WARNING: The instructions on this sheet are abbreviated instructions only and are provided solely as a customer service. They are not meant to replace the machine's operation manual. If you are unsure of the machine's safe and proper operation, please review the operating and safety information in the operator's manual provided with the machine

Tool Operation:

Step	Action
1	Check all hardware for tightness, and make sur strainer is supplied with hose
2	Prior to starting: Check that hoses are securely attached to pump. Suction hose (2.1) must not have any air leaks. Tighten hose clamps and couplings. Check that discharge hose (2.2) is not restricted. Lay hose out as straight as possible. Remove any twists or sharp bends from hose which may block the flow of water. Check engine oil and fuel level (2..3.4.5.6) To prime pump, remove prime plug (2.7) and fill pump case with water. If pump is not filled with water before starting. It will not pump. WARNING: Do not open priming plug, discharge plug, or loosen hose fittings if pump is hot! Water or vapor inside pump may be under pressure.
3	To Start: Set throttle to low position (3.1) and place engine swith to "on" (3.2). Move choke lever to upward position (3.3) and grasp starter rope (3.4) pulling in short rapid motions (3.5). When engine starts and warms, move choke lever downward (3.6)
4	To Pump: Move throttle from idel position (4.1) to full throttle position (4.2). Make sure suction hose (2.1) is submersed in water and that factory supplied strainer is installed!
5	To Stop: Retrun throttle to the idle position (5.1) and set engine swith to the off position (5.2)
6	Remove pump housing drain plug and drain water for case after each use (6.1).

